

PROJECT: 50138.3.169 TIP: W-5601FL

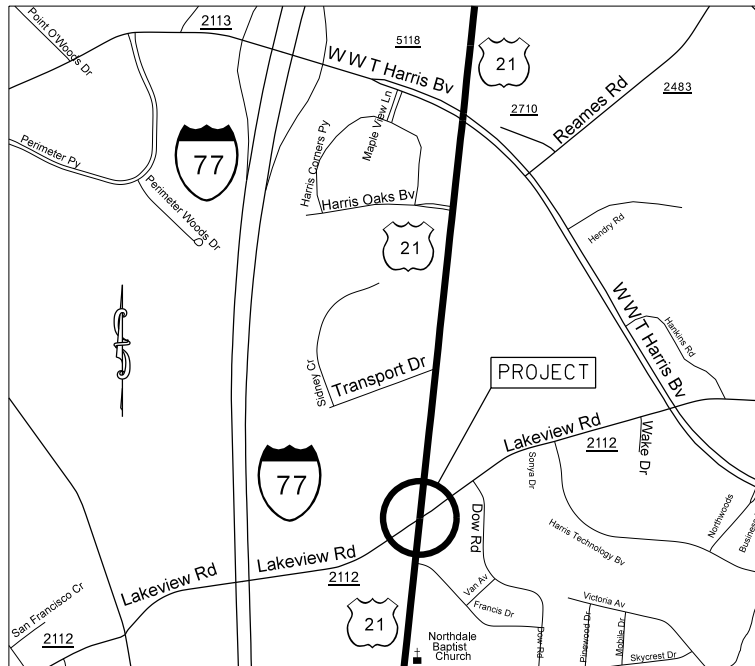

VICINITY MAP NOT TO SCALE

STATE OF NORTH CAROLINA
DIVISION OF HIGHWAYS
MECKLENBURG COUNTY

LOCATION: INTERSECTION OF US 21 (STATESVILLE RD.) AND LAKEVIEW ROAD (SR-2112)

TYPE OF WORK: GRADING, PAVING, MILLING, THERMOPLASTIC PAVEMENT MARKING, AND TRAFFIC SIGNAL.

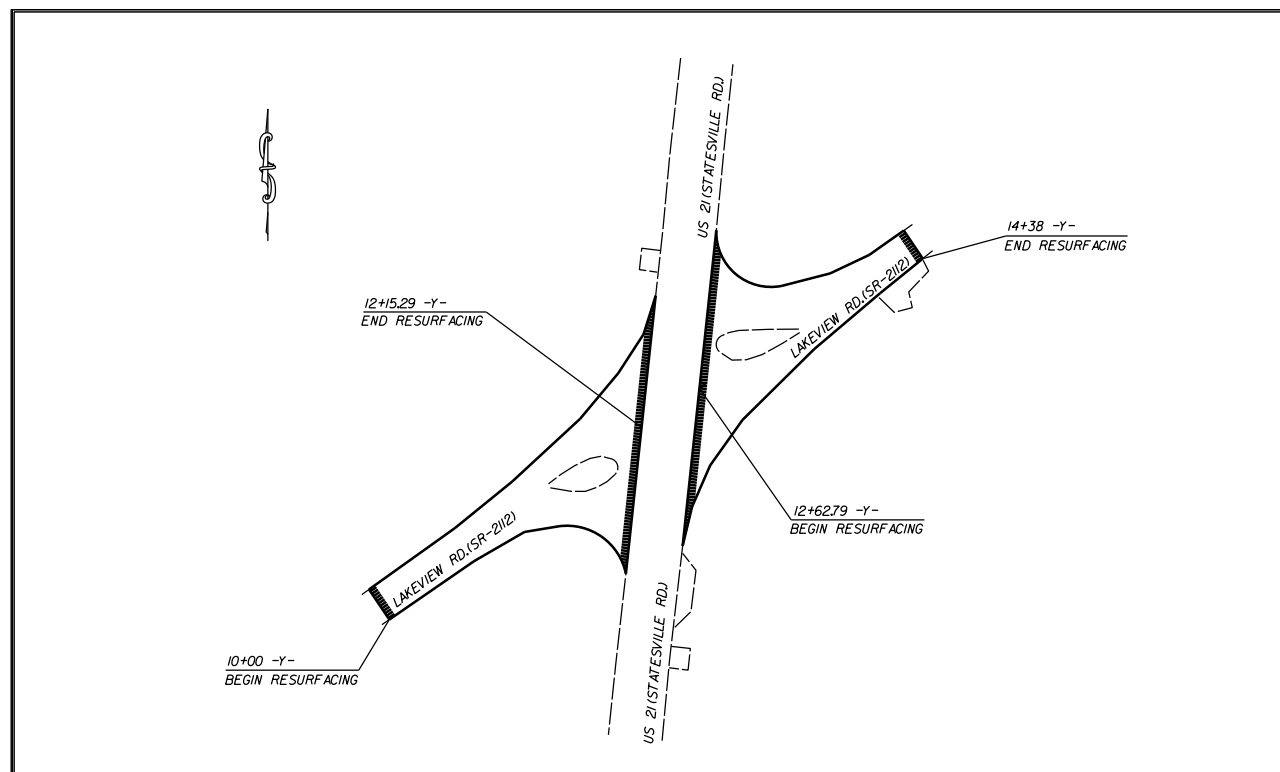

CLEARING ON THIS PROJECT SHALL BE TO THE LIMITS ESTABLISHED BY METHOD II AS DESCRIBED IN THE NCDOT STANDARD DRAWINGS

STATE	STATE PROJECT REFERENCE NO.	SHEET NO.	TOTAL SHEETS
N.C.	50138.3.169	1	
STATE PROJ. NO.	F.A. PROJ. NO.	DESCRIPTION	
50138.1.169	HSIP-0077(007)	P.E.	
50138.3.169	HSIP-0077(007)	RW	
		CONST.	

GRAPHIC SCALES

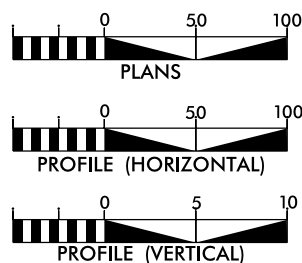

DESIGN DATA

ADT =
ADT =
DHV = %
D = %
T = %
V = MPH

PROJECT LENGTH

LENGTH OF ROADWAY PROJECT 50138.3.169 = 0.08 MILES
TOTAL LENGTH OF STATE PROJECT 50138.3.169 = 0.08 MILES

Prepared in the Office of:
DIVISION OF HIGHWAYS

DIVISION TEN
DIVISION DESIGN / CONSTRUCT UNIT

RIGHT OF WAY DATE:

LETTING DATE:
November 1, 2017

DONALD GRIFFITH
PROJECT ENGINEER

DONALD HARWARD
PROJECT DESIGN ENGINEER



ROADWAY DESIGN ENGINEER



DocuSigned by
Michael Eberlein
002E76C0FFB43B...

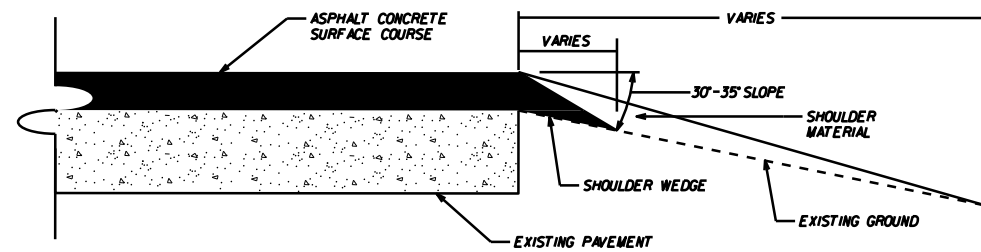
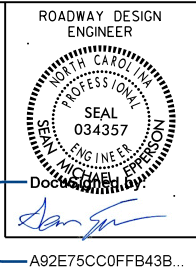

SHOULDER WEDGE DETAIL

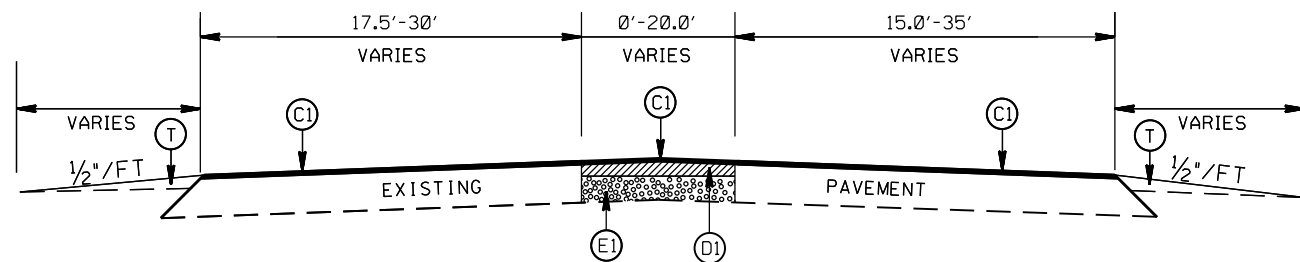

TYPICAL SECTION NO. 2
 STA. 11+38.00 TO 11+88.00 -Y-
 STA. 12+62.79 TO 12+88.00 -Y-

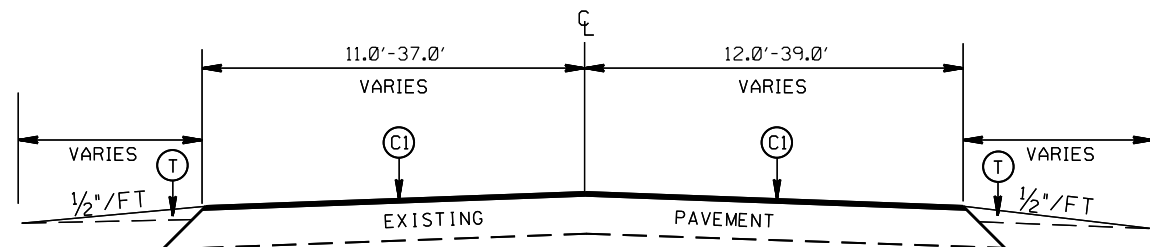

TYPICAL SECTION NO. 1
 STA. 10+00.00 TO 11+38.00 -Y-
 STA. 11+88.00 TO 12+15.29 -Y-
 STA. 12+62.79 TO 12+88.00 -Y-
 STA. 13+45.00 TO 14+38.00 -Y-

PAVEMENT SCHEDULE

(C1)	PROP. APPROX. 1½" ASPHALT CONC. SURFACE COURSE, TYPE S9.5B, AT AN AVERAGE RATE OF 168 LBS. PER SQ. YD.
(D1)	PROP. APPROX. 2½" ASPHALT CONC. INTERMEDIATE COURSE, TYPE I19.0B, AT AN AVERAGE RATE OF 285 LBS. PER SQ. YD.
(E1)	PROP. APPROX. 8.0" ASPHALT CONC. BASE COURSE, TYPE B25.0B, AT AN AVERAGE RATE OF 456 LBS. PER SQ. YD. IN EACH OF TWO LAYERS.
(T)	EARTH MATERIAL

SIGNALIZING INTERSECTION AT
 US 21 (STATESVILLE RD.)
 AND LAKEVIEW RD. (SR-2112)

SCALE	r=50'
DATE	8-2018
DWG. BY	DLS
DESIGN BY	JDH
APPROVED	DCG



REVISIONS	

PROJECT NO.	SHEET NO.
50138.3.169	3
F.A. PROJECT NO. HSP-007(007)	

ROADWAY DESIGN
ENGINEER

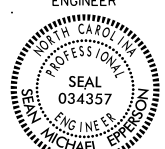

DocuSign by:

Michael J. Murphy

A92E75CC0FFB43B...

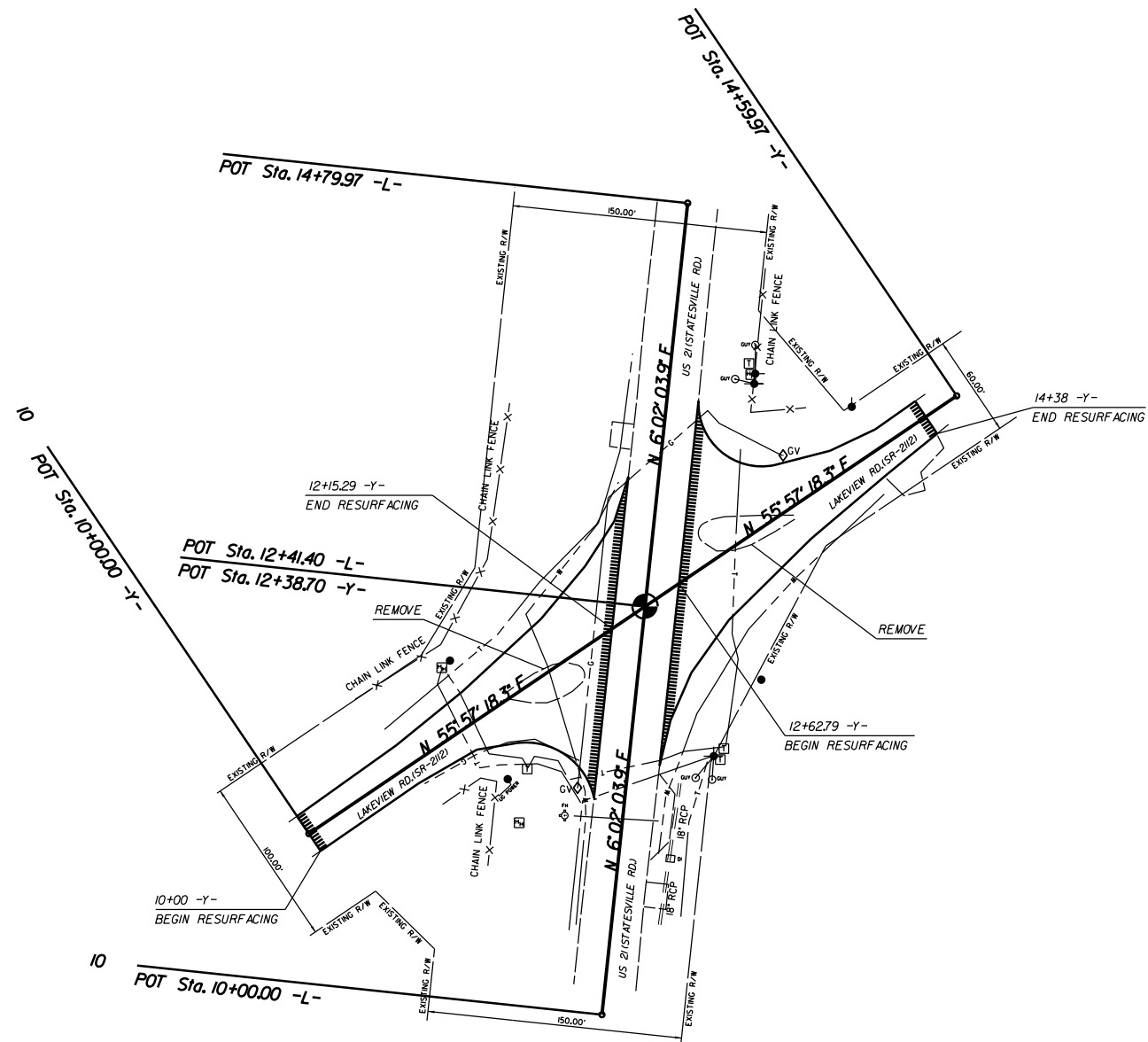

NOTE: INCIDENTAL MILL APPROX. 25' AT EACH
TIE IN TO PROVIDE A SMOOTH TRANSITION
TO THE EXISTING ASPHALT PAVEMENT.

US 21 (STATESVILLE RD.)
AT LAKEVIEW RD.(SR-2112)

SCALE	1"=50'
DATE	8-2018
DWG. BY	DLS
DESIGN BY	JDH
APPROVED	DCG



REVISIONS

ROADWAY DESIGN ENGINEER

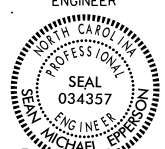

DocuSign by: *Michael J. ...*

A92E75CC0FFB43B...

PAVEMENT MARKING SCHEDULE

PAVEMENT MARKING LINES

- | | |
|--|---|
| TA - WHITE EDGELINE (4',.90 MIL) | TU - WHITE DIAGONAL (12',.90 MIL) |
| TB - YELLOW EDGELINE (4',.90 MIL) | TV - YELLOW DIAGONAL (12',.90 MIL) |
| TC - 10FT. WHITE SKIP (4',.120 MIL) | TI - WHITE LINE, RR X (16',.120 MIL) |
| TD - 3FT.-9FT./SP WHITE MINISKIP (4',.120 MIL) | T2 - WHITE STOPBAR (24',.120 MIL) |
| TE - WHITE SOLID LANE LINE (4',.120 MIL) | T3 - WHITE CROSSWALK LINE (24',.120 MIL) |
| TF - 10FT. YELLOW SKIP (4',.120 MIL) | T4 - WHITE RUMBLE STRIP (4',.240 MIL) |
| TH - YELLOW SINGLE CENTER (4',.120 MIL) | T5 - YELLOW RUMBLE STRIP (4',.240 MIL) |
| TJ - YELLOW DOUBLE CENTER (4',.120 MIL) | T6 - WHITE EDGELINE (6',.90 MIL) |
| TK - 3FT.-9FT./SP WHITE MINISKIP (6',.120 MIL) | T7 - YELLOW EDGELINE (6',.90 MIL) |
| TL - WHITE SOLID LANE LINE (6',.120 MIL) | T8 - 2FT.-6FT./SP WHITE MINISKIP (4',.120 MIL) |
| TM - 10FT. YELLOW SKIP (6',.120 MIL) | T9 - 2FT.-6FT./SP YELLOW MINISKIP (4',.120 MIL) |
| TN - WHITE GORELINE (8',.90 MIL) | T10 - 3FT.-3FT./SP WHITE MINISKIP (12',.120 MIL) |
| TO - WHITE DIAGONAL (8',.90 MIL) | T11 - 2FT.-6FT./SP WHITE MINISKIP (6',.120 MIL) |
| TP - YELLOW DIAGONAL (8',.90 MIL) | T12 - 2FT.-6FT./SP YELLOW MINISKIP (6',.120 MIL) |
| TQ - WHITE CROSSWALK LINE (8',.120 MIL) | T13 - 3FT.-9FT./SP WHITE MINISKIP (8',.120 MIL) |
| TR - WHITE SOLID LANE LINE (8',.120 MIL) | T14 - 3FT.-9FT./SP WHITE MINISKIP (12',.120 MIL) |
| TS - WHITE GORELINE (12',.90 MIL) | T15 - YELLOW SINGLE CENTER (6',.120 MIL) |
| TT - WHITE SOLID LANE LINE (12',.120 MIL) | T16 - YELLOW DOUBLE CENTER (6',.120 MIL) |
| | T17 - 3FT.-3FT./SP WHITE MINISKIP ENTRANCE LINE (8',.120 MIL) |

PAVEMENT MARKING SYMBOLS

- | | |
|--|--|
| UA - LEFT TURN ARROW (90 MIL) | UU - FISH-HOOK STRAIGHT ARROW (90 MIL) |
| UB - RIGHT TURN ARROW (90 MIL) | UV - FISH-HOOK LEFT/STRAIGHT ARROW (90 MIL) |
| UC - STRAIGHT ARROW (90 MIL) | UW - FISH-HOOK RIGHT/STRAIGHT ARROW (90 MIL) |
| UD - COMBO. LEFT/STRAIGHT ARROW (90 MIL) | UX - FISH-HOOK LEFT/RIGHT ARROW (90 MIL) |
| UE - COMBO. RIGHT/STRAIGHT ARROW (90 MIL) | UY - FISH-HOOK LEFT/RIGHT/STRAIGHT ARROW (90 MIL) |
| UF - COMBO. LEFT/RIGHT ARROW (90 MIL) | UZ - FISH-HOOK W/CIRCLE STRAIGHT ARROW (90 MIL) |
| UG - COMBO. LEFT/RIGHT/STRAIGHT ARROW (90 MIL) | |
| UH - HANDICAP PARKING (90 MIL) | WA - FISH-HOOK W/CIRCLE LEFT ARROW (90 MIL) |
| UI - ALPHANUMERIC CHAR. (120 MIL) | WB - FISH-HOOK W/CIRCLE LEFT/STRAIGHT ARROW (90 MIL) |
| UJ - BICYCLE SYMBOL (90 MIL) | WC - FISH-HOOK W/CIRCLE LEFT/RIGHT/STRAIGHT ARROW (90 MIL) |
| UK - BICYCLE STRAIGHT ARROW (90 MIL) | |
| UL - BICYCLE CHAR. (120 MIL) | MA - PERMANENT RAISED MARKER (YELLOW & YELLOW) |
| UM - 12" YIELD LINE TRIANGLE (90 MIL) | MB - PERMANENT RAISED MARKER (CRYSTAL & RED) |
| UN - 24" YIELD LINE TRIANGLE (90 MIL) | MC - PERMANENT RAISED MARKER (YELLOW & RED) |
| UO - BICYCLE LEFT ARROW (90 MIL) | MD - PERMANENT RAISED MARKER (YELLOW) |
| UP - MERGE ARROW (90 MIL) | ME - SNOWFLOWABLE MARKER (YELLOW & YELLOW) |
| UQ - RAMP ARROW SYMBOL (90 MIL) | MF - SNOWFLOWABLE MARKER (CRYSTAL & RED) |
| UR - SHARROW (90 MIL) | MG - SNOWFLOWABLE MARKER (YELLOW & RED) |
| US - BICYCLE LOOP DETECTOR (90 MIL) | ML - PERMANENT RAISED MARKER (CRYSTAL & CRYSTAL) |
| UT - U-TURN ARROW (90 MIL) | MO - SNOWFLOWABLE MARKER (CRYSTAL & CRYSTAL) |

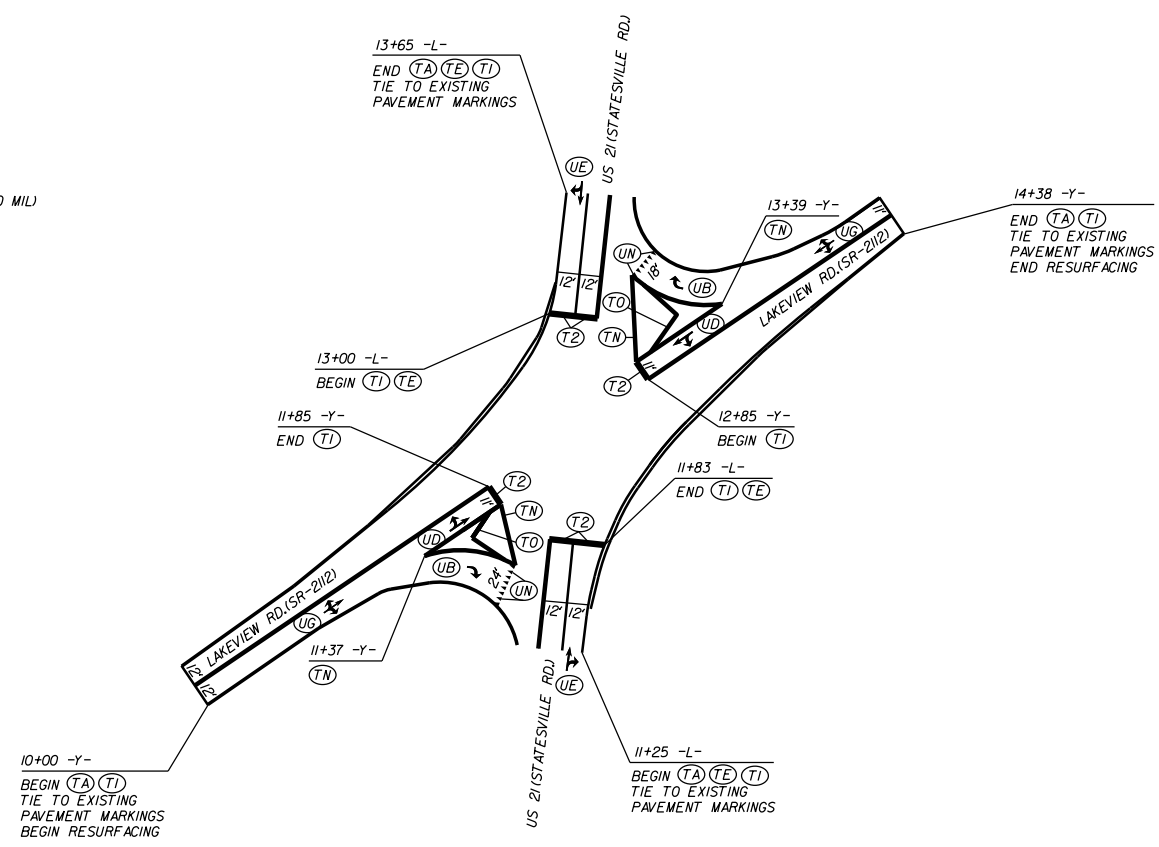

SIGNALIZING INTERSECTION AT
US 21 (STATESVILLE RD.)
AND LAKEVIEW RD. (SR-2112)

SCALE	1"=50'		REVISIONS
DATE	8-2018		
DWG. BY	DLS		
DESIGN BY	JDH		
APPROVED	DCG		

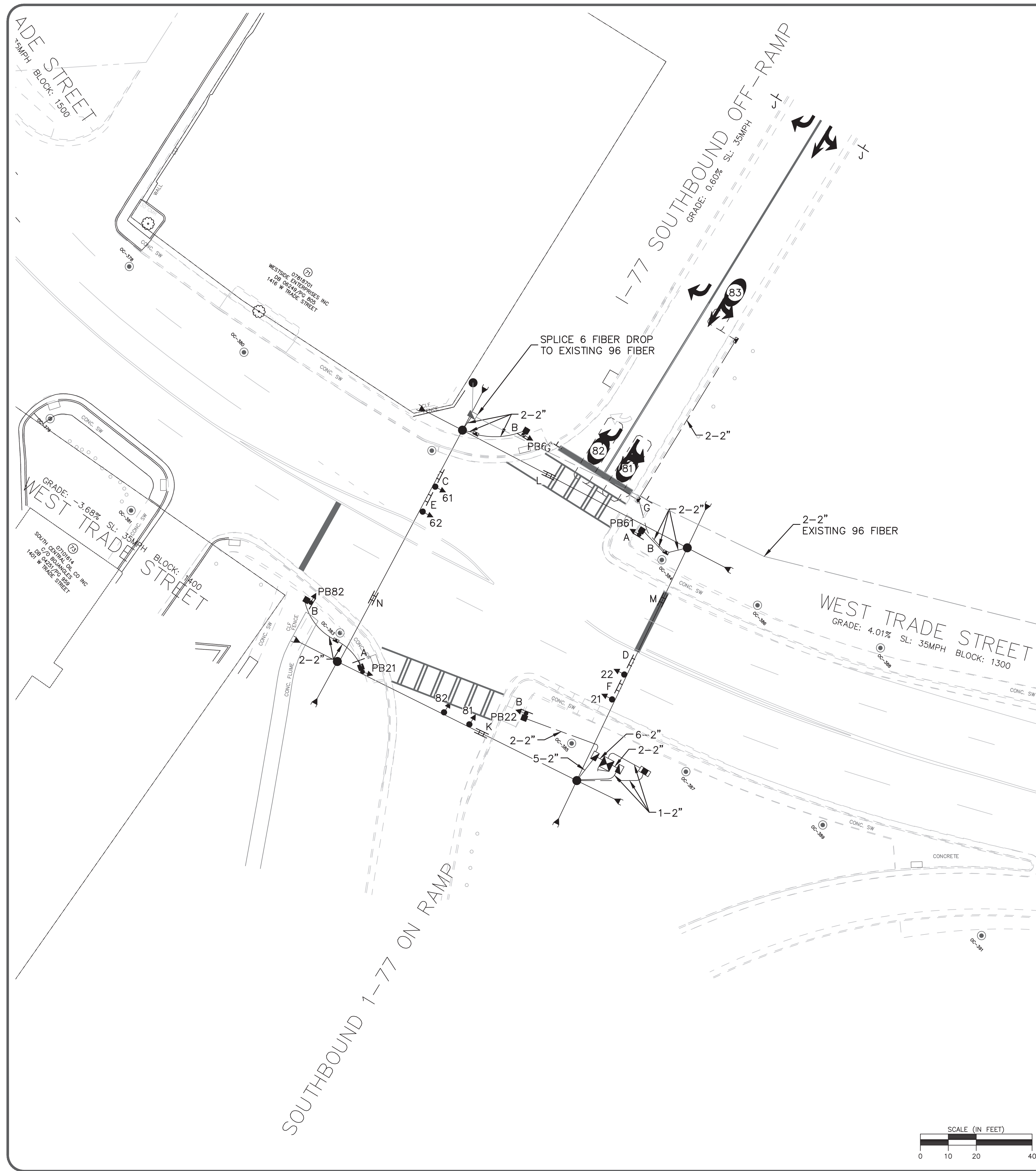

SIGNAL PHASING		SIGNAL SEQUENCE								CLEARANCE INTERVALS							
Ring Configuration: 1,2,3,4,5,6,7,8,9		RING 1 PHASE 1 PHASE 2 PHASE 3 PHASE 4								Phase 1 2 3 4 5 6 7 8							
CONTROLLER TYPE: ECONOLITE ASC/3		SIGNAL ID NUMBER								% Grade							
ECONOLITE ASC/3		21,22								-3.7%							
1 NOT USED		PB21,PB22								105							
2 NOT USED										35							
3 NOT USED										4.1							
4 NOT USED										2.1							
5 NOT USED										6.2							
6 NOT USED										5.5							
7 NOT USED																	
8 NOT USED																	
9 NOT USED																	
10 NOT USED																	

TRAFFIC VOLUMES															
RING 2 PHASE 5 PHASE 6 PHASE 7 PHASE 8															
SIGNAL ID NUMBER															
61,62															
81,82															
PB61,PB62															

OVERLAP - PHASE															
OVERLAP - PHASE															
SIGNAL ID NUMBER															
R/W OTH R/W OTH R/W OTH R/W OTH															
R/W OTH R/W OTH R/W OTH R/W OTH															
R/W OTH R/W OTH R/W OTH R/W OTH															
R/W OTH R/W OTH R/W OTH R/W OTH															

DETECTOR INFORMATION															
DETECTOR AMP. SIZE / AMP. DELAY COMMENTS:															
81 1 6'x25' 8 N STOPBAR (THRU/RIGHT)															
82 2 6'x25' 8 D 8 STOPBAR (LEFT)															
83 3 6'x6' 8 N 70' FROM STOPBAR															

PULLBOX ID	
SIZE:	PULLBOX TYPE:
13"x24"x12"	LOOP
17"x30"x24"	FIBER OPTIC
24"x36"x24"	CONTROLLER / FIBER
30"x48"x36"	CONTROLLER
24"x24"x12"	CONTROLLER
36"x36"x12"	CONTROLLER

SIGNAL HEAD ID	
21,22	PB21,PB22
61,62	PB61,PB62
81,82	PB81,PB82

SIGN ID		LEGEND	
A R10-3b (L)	B R10-3b (R)	PROPOSED	EXISTING
C R3-1 24" x 24"	D R3-2 30" x 30"	CONTROL BOX	METER PEDESTAL
F R6-1R 48" x 18"	G R5-1 30" x 30"	PULL BOX	STEEL POLE
J R5-1a 36" x 24"	K W. Trade St. 1200	MAST ARM	PED PEDESTAL
	L W. Trade St. 1300	UTILITY POLE	ANCHOR
	M S. I-77 On Ramp	SIGNAL HEAD	VIDEO CAMERA
	N S. I-77 Off Ramp	OPTICOM	OBSERVATION CAM
		DETECTOR	CONDUIT
		INTERCONNECT	EDGE OF PWMT.
		CURB & GUTTER	TUBULAR MARKER
		GROUND SIGN	OVERHEAD SIGN
		DOUBLE YELLOW	STOP BAR
		WHITE SKIP	WHITE MINI
		PAVEMENT ARROW	PROPERTY LINE
		ROW	

PLAN NOTES

- ALL PAVEMENT MARKING DIMENSIONS ARE APPROXIMATE.
- SIGNAL WILL BE INSTALLED IN ACCORDANCE WITH THE MAY 1998 CDOT TRAFFIC SIGNAL SPECIFICATIONS AND THE PROJECT SPECIAL PROVISIONS.
- PED SIGNALS WITH PUSHBUTTONS WILL BE LABELED "PB" (FOR EXAMPLE PB21, PB22)
- COUNTDOWN PEDESTRIAN SIGNALS SHOULD COUNT DOWN FLASHING DON'T WALK ONLY.

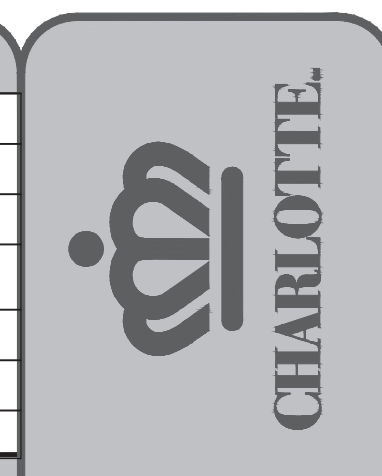

Plans Prepared By:
City of Charlotte
 Department of Transportation
 600 East Fourth Street
 Charlotte, North Carolina 28202
 Phone: (704) 336-4119

NO.	DATE	BY	DESCRIPTION

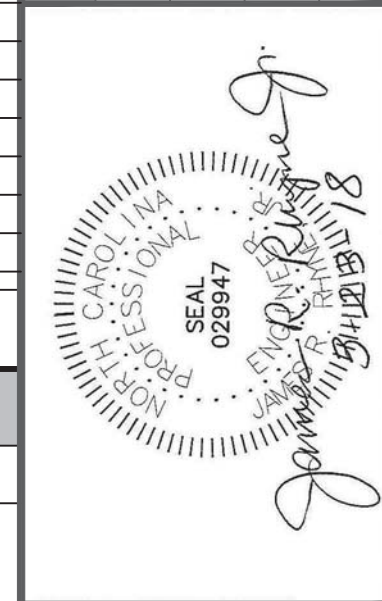

512-14-1522	SCALE	1" = 20'
JOB NO.	NA	
SIGNAL ID	NA	
PREPARED BY	TLB	
CHECKED BY	NLC	
APPROVED BY	JBR	
DATE	04/12/2016	

WEST TRADE STREET
 AND
 I-77 SOUTHBOUND RAMP

SHEET
 SG-06
 OF
 SG-30

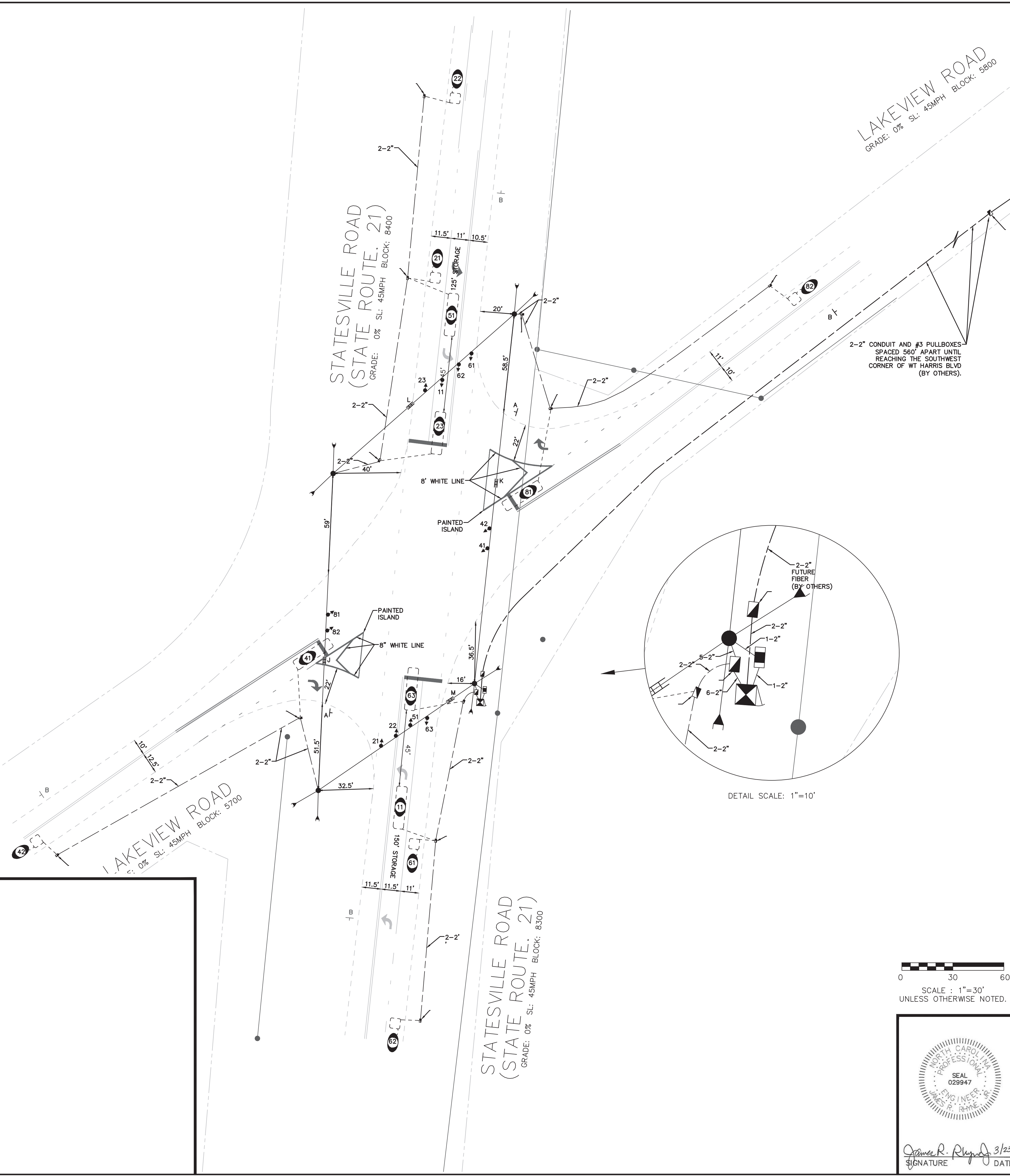

SIGNAL PHASING		SIGNAL SEQUENCE								CLEARANCE INTERVALS									
Ring Configuration 1, 2, 3, 4, 5, 6, 7, 8		RING 1		PHASE 1		PHASE 2		PHASE 3		PHASE 4		PHASE 5		PHASE 6		PHASE 7		PHASE 8	
CONTROLLER TYPE: 2070 ASC/3		SIGNAL ID NUMBER		R/W	OTH	R/W	OTH	R/W	OTH	R/W	OTH	R/W	OTH	R/W	OTH	R/W	OTH	FLASH	% GRADE
1	5	21,22,23	41,42			G	Y												---
2	6																		---
3	7																		---
4	8																		---

OVERLAP - PHASE		SIGNAL SEQUENCE												
OVERLAP PHASE	OL-A/1+2	OL-B/-/+	OL-C/5+6	OL-D/-/+	RING 2		PHASE 5		PHASE 6		PHASE 7		PHASE 8	
SIGNAL ID NUMBER	R/W	OTH	R/W	OTH	R/W	OTH	R/W	OTH	R/W	OTH	R/W	OTH	R/W	OTH
11A														
51A														

PULLBOX ID		SIGNAL HEAD ID	
SIZE	PULLBOX TYPE	Symbol	Label
13"x24"x12"	LOOP	(Symbol)	11A, 51A
17"x30"x24"	FIBER OPTIC	(Symbol)	11A, 51A
24"x36"x24"	CONTROLLER / FIBER	(Symbol)	11A, 51A
30"x48"x36"	CONTROLLER	(Symbol)	11, 51
24"x24"x12"	CONTROLLER	(Symbol)	
36"x36"x12"	CONTROLLER	(Symbol)	

TRAFFIC VOLUMES		DETECTOR INFORMATION	
STREET NAME	COUNTS NOT AVAILABLE	DETECTOR NUMBER	AMP NO. / SIZE / ZONE
STATESVILLE ROAD		11	1 6x25 1 D 1
LAKEVIEW ROAD		21	2 6x6 2 S ---
		22	3 6x6 2 S ---
		23	4 6x25 2 N ---
		41	5 6x25 4 N ---
		42	6 6x6 4 S ---
		51	7 6x25 5 D 5
		61	8 6x6 6 S ---
		62	9 6x6 6 S ---
		63	10 6x25 6 N ---
		81	11 6x25 8 N ---
		82	12 6x6 8 S ---
		---	13 --- --- ---
		---	14 --- --- ---
		---	15 --- --- ---
		---	16 --- --- ---
		---	17 --- --- ---
		---	18 --- --- ---
		---	19 --- --- ---

SIGN ID		LEGEND	
Symbol	Label	PROPOSED	EXISTING
(Yield Sign)	A R1-2 36"	(Symbol)	(Symbol)
(Speed Limit Sign)	B R2-1-45 30" x 36"	(Symbol)	(Symbol)
(Statesville Sign)	J R1 8300	(Symbol)	(Symbol)
(Statesville Sign)	K R1 8400	(Symbol)	(Symbol)
(Lakeview Sign)	L R1 5700	(Symbol)	(Symbol)
(Lakeview Sign)	M R1 5800	(Symbol)	(Symbol)

PLAN NOTES

- ALL PAVEMENT MARKING DIMENSIONS ARE APPROXIMATE.
- SIGNAL WILL BE INSTALLED IN ACCORDANCE WITH THE MAY 1998 CDOT TRAFFIC SIGNAL SPECIFICATIONS AND THE PROJECT SPECIAL PROVISIONS.
- PED SIGNALS WITH PUSHBUTTONS WILL BE LABELED "PB" (FOR EXAMPLE PB21, PB22)
- COUNTDOWN PEDESTRIAN SIGNALS SHALL COUNT DOWN FLASHING DON'T WALK ONLY.
- FYA 11 AND 51 WILL INITIALLY OPERATE 24/7.

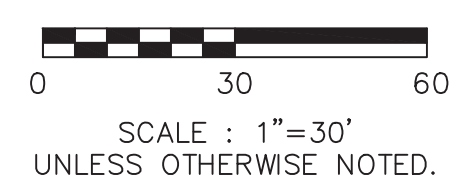

SEAL 029947
 ENGINEER
 JAMES S. RYAN, P.E.
 Signature: James R. Ryan 3/23/18
 DATE

DESIGNED BY: MKC | DATE: 1/24/17 | APPROVED BY: BG | NCDOT# 10-1703 | UNIT ID: 4175 | SIGNAL ID: 01743

CITY OF CHARLOTTE
 DEPARTMENT OF TRANSPORTATION
 600 E. 4TH ST. CHARLOTTE, NC 28202 704 336-4119 FAX: 704 336-4400

STATESVILLE ROAD
 AND
 LAKEVIEW ROAD



SIGNAL PHASING		SIGNAL SEQUENCE								CLEARANCE INTERVALS																
Ring Configuration	1, 2, 3, 4	RING 1	PHASE 1	PHASE 2	PHASE 3	PHASE 4	FLASH	PHASE 1	2	3	4	5	6	7	8	PHASE 5	PHASE 6	PHASE 7	PHASE 8							
CONTROLLER TYPE:	2070 ASC/3	SIGNAL ID NUMBER	R/W	OTH	R/W	OTH	R/W	OTH	R/W	OTH	FLASH	% GRADE	---							---						
1	NOT USED	5	NOT USED									APPROACH SPEED (mph)	---							---						
2	NOT USED	6	NOT USED									ALL RED	---							---						
3	NOT USED	7	NOT USED									YELLOW	---							---						
4	NOT USED	8	NOT USED									TOTAL CLEARANCE	---							---						
NOTE: CLEARANCE INTERVAL DATA IS NOT LINKED.																										
TRAFFIC VOLUMES																										
STREET NAME																										
COUNTS NOT AVAILABLE																										
STREET NAME																										
DETECTOR INFORMATION																										
STREET NAME																										
COMMENTS:																										
31 1 6x25 3 D 3 65' FROM SB																										
41 2 6x25 N SB (LT)																										
3 3 --- --- ---																										
4 4 --- --- ---																										
5 5 --- --- ---																										
6 6 --- --- ---																										
7 7 --- --- ---																										
8 8 --- --- ---																										
9 9 --- --- ---																										
10 10 --- --- ---																										
11 11 --- --- ---																										
12 12 --- --- ---																										
13 13 --- --- ---																										
14 14 --- --- ---																										
15 15 --- --- ---																										
16 16 --- --- ---																										
17 17 --- --- ---																										
18 18 --- --- ---																										
19 19 --- --- ---																										
NOTE: ALL STOPBAR LOOPS EXTEND 5' BEYOND THE STOPBAR UNLESS OTHERWISE NOTED. ALL LOOPS RECEIVE THREE TURNS.																										

PULLBOX ID		SIGNAL HEAD ID			SIGN ID			LEGEND		
SIZE:	PULLBOX TYPE:	RED ARROW	YELLOW ARROW	A	B	C	PROPOSED	DESCRIPTION	EXISTING	
13"x24"x12"	LOOP	GREEN ARROW	FLASHING YELLOW ARROW	AIR MARKER 6" x 23"	R4-7 24" x 30"	R3-4 24" x 24"	CONTROL BOX	METER PEDESTAL	PULL BOX	
17"x30"x24"	FIBER OPTIC							STEEL POLE	MAST ARM	
24"x36"x24"	CONTROLLER / FIBER							PED PEDESTAL	UTILITY POLE	
30"x48"x36"	CONTROLLER							ANCHOR	SIGNAL HEAD	
24"x24"x12"	CONTROLLER							VIDEO CAMERA	OPTICOM	
36"x36"x12"	CONTROLLER							OBSERVATION CAM	DETECTOR	
NOTE: PULLBOX MATERIAL MUST MEET OR EXCEED THE 1998 CDOT TRAFFIC SIGNAL SPECIFICATIONS.								CONDUIT	INTERCONNECT	
								EDGE OF PWMT.	CURB & GUTTER	
								TUBULAR MARKER	GROUND SIGN	
								OVERHEAD SIGN	DOUBLE YELLOW	
								STOP BAR	WHITE SKIP	
								WHITE MINI	PAVEMENT ARROW	
								PROPERTY LINE	ROW	

PLAN NOTES

- ALL PAVEMENT MARKING DIMENSIONS ARE APPROXIMATE.
- SIGNAL WILL BE INSTALLED IN ACCORDANCE WITH THE MAY 1998 CDOT TRAFFIC SIGNAL SPECIFICATIONS AND THE PROJECT SPECIAL PROVISIONS.
- PED SIGNALS WITH PUSHBUTTONS WILL BE LABELED "PB" (FOR EXAMPLE PB21, PB22)
- COUNTDOWN PEDESTRIAN SIGNALS SHALL COUNT DOWN FLASHING DON'T WALK ONLY.
- FYA #31 WILL INITIALLY RUN 24/7.

#	BY:	DATE:	REVISION:

DESIGNED BY: MKC | DATE: 9/12/16 | APPROVED BY: BG | NCDOT# 10-2245 | UNIT ID: 23501 | SIGNAL ID: 01744

CITY OF CHARLOTTE
DEPARTMENT OF TRANSPORTATION
600 E. 4TH ST. CHARLOTTE, NC 28202 704 336-4119 FAX: 704 336-4400

I-77 NB RAMP
AND
WESTINGHOUSE BOULEVARD

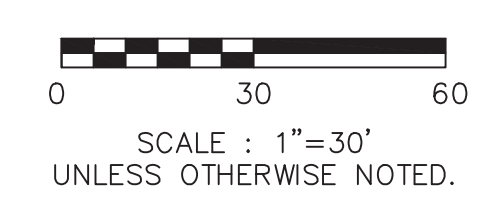

SCALE: 1"=30'
UNLESS OTHERWISE NOTED.

James R. Ryan 3/23/18
SIGNATURE DATE

SEAL
029947
ENGINEER
NORTH CAROLINA PROFESSIONAL

SPLICE DETAIL NOT AVAILABLE



E. W.T. HARRIS BOULEVARD E.B. RAMP
GRADE: +3.0% SL: 35MPH BLOCK: RAMP

OLD CONCORD ROAD
GRADE: 0.0% SL: 45MPH BLOCK: 8800

Utility Owner: UTILITYOWNER
Attachment Neutral/Secd. --- ft. Misc. Utility --- ft.
Heights: CDOT Span 1 --- ft. CDOT --- ft.
Span 2 --- ft. Interconnect --- ft.

Utility Owner: UTILITYOWNER
Attachment Neutral/Secd. --- ft. Misc. Utility --- ft.
Heights: CDOT Span 1 --- ft. CDOT --- ft.
Span 2 --- ft. Interconnect --- ft.

Utility Owner: UTILITYOWNER
Attachment Neutral/Secd. --- ft. Misc. Utility --- ft.
Heights: CDOT Span 1 --- ft. CDOT --- ft.
Span 2 --- ft. Interconnect --- ft.

Utility Owner: UTILITYOWNER
Attachment Neutral/Secd. --- ft. Misc. Utility --- ft.
Heights: CDOT Span 1 --- ft. CDOT --- ft.
Span 2 --- ft. Interconnect --- ft.

SIGNAL PHASING		SIGNAL SEQUENCE								CLEARANCE INTERVALS							
Ring Configuration	1,2,3,4,5	RING 1	PHASE 1	PHASE 2	PHASE 3	PHASE 4	FLASH	Phase	1	2	3	4	5	6	7	8	
CONTROLLER TYPE:		SIGNAL ID NUMBER	R/W	OTH	R/W	OTH	R/W	OTH	Y								
ENTER CONTROLLER TYPE HERE		21,22			G	Y											
		41,42						G	Y	R							
1	NOT USED	5	NOT USED														
2		6															
3	NOT USED	7	NOT USED														
4		8	NOT USED														
9	NOT USED	11	NOT USED														
10	NOT USED	12	NOT USED														

TRAFFIC VOLUMES		OVERLAP - PHASE											
RING 2	PHASE 5	PHASE 6	PHASE 7	PHASE 8	FLASH	SIGNAL ID NUMBER			SIGNAL ID NUMBER				
61,62		G	Y										

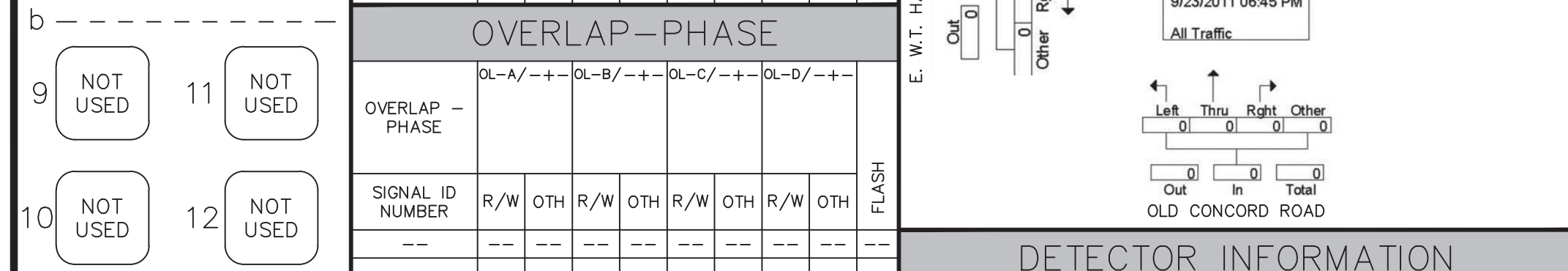

PULLBOX ID		SIGNAL HEAD ID	
SIZE	PULLBOX TYPE	RED ARROW	YELLOW ARROW
13"x24"x12"	LOOP		
17"x30"x24"	FIBER OPTIC		
24"x36"x24"	CONTROLLER / FIBER		
30"x48"x36"	CONTROLLER		
24"x24"x12"	CONTROLLER		
36"x36"x12"	CONTROLLER		

DETECTOR INFORMATION				
DETECTOR NUMBER	AMP. NO. / SIZE / ZONE / #	AMP. TYPE	DELAY	COMMENTS
21,22	1 6x6 2 N	N	---	95' & 200' FROM STOP BAR
41,42	2 6x25 4 N	N	---	STOP BAR
61,62	3 6x6 6 N	N	---	95' & 200' FROM STOP BAR
63	4 6x25 6 N	N	---	STOP BAR
---	5	---	---	---
---	6	---	---	---
---	7	---	---	---
---	8	---	---	---
---	9	---	---	---
---	10	---	---	---
---	11	---	---	---
---	12	---	---	---
---	13	---	---	---
---	14	---	---	---
---	15	---	---	---
---	16	---	---	---
---	17	---	---	---
---	18	---	---	---
---	19	---	---	---

SIGN ID

A R1-2 36"

B R4-7 24" x 30"

C R5-1 30" x 30"

D R5-1a 36" x 24"

E

F

G R1-1 30" x 30" REMOVE

J OM4-3 18" x 18"

K W1-7 48" x 24"

LEGEND

PROPOSED	DESCRIPTION	EXISTING
	CONTROL BOX	
	METER PEDESTAL	
	PULL BOX	
	STEEL POLE	
	MAST ARM	
	PED PEDESTAL	
	UTILITY POLE	
	ANCHOR	
	SIGNAL HEAD	
	VIDEO CAMERA	
	OPTICOM	
	OBSERVATION CAM	
	DETECTOR	
	CONDUIT	
	INTERCONNECT	
	EDGE OF PWMT.	
	CURB & GUTTER	
	TUBULAR MARKER	
	GROUND SIGN	
	OVERHEAD SIGN	
	DOUBLE YELLOW	
	STOP BAR	
	WHITE SKIP	
	WHITE MINI	
	PAVEMENT ARROW	
	PROPERTY LINE	
	ROW	

PLAN NOTES

- ALL PAVEMENT MARKING DIMENSIONS ARE APPROXIMATE.
- SIGNAL WILL BE INSTALLED IN ACCORDANCE WITH THE MAY 1998 CDOT TRAFFIC SIGNAL SPECIFICATIONS AND THE PROJECT SPECIAL PROVISIONS.
- PED SIGNALS WITH PUSH-BUTTONS WILL BE LABELED "PB" (FOR EXAMPLE PB21, PB22)
- COUNTDOWN PEDESTRIAN SIGNALS SHALL COUNT DOWN FLASHING DON'T WALK ONLY.

#	BY:	DATE:	REVISION:

CITY OF CHARLOTTE
DEPARTMENT OF TRANSPORTATION
600 E. 4TH ST. CHARLOTTE, NC 28202 704 336-4119 FAX: 704 336-4400

OLD CONCORD ROAD
AND
E. WT HARRIS BOULEVARD EB RAMP

DESIGNED BY: JRR DATE: 9/16/16 APPROVED BY: APR NCDOT ###-##### UNIT ID: 6657 SIGNAL ID: 01746



James R. Ruffolo 3/23/18
SIGNATURE DATE

SPLICE DETAIL NOT AVAILABLE

